

Project:	
Type:	
Catalog #:	



## SPECIFICATIONS: INTERNAL

AC ONLY, AC/DC and SELF-POWERED comes standard configured with high-output LED technology, 120/277VAC input. Nickel-cadmium batteries provide a minimum 90 minutes of emergency duration. Optional 120 minute duration battery is available. Solid state charger & transfer. Standard with 120/277VAC input and consume only 2W nominal power. CSA 22.2 No. 141 Performance Certified. CWZ signs configured for AC/DC operation feature a universal 2 wire DC input; 6VDC - 24VDC. Fuse protection is standard.

## SPECIFICATIONS: EXTERNAL

The CWZ series housing is constructed from durable die-cast aluminum. The acrylic faceplate is universal and can be configured for both single face or double face and includes field installable inserts that allow for clear, mirror or white panel backgrounds. The CWZ allows the installer to choose between surface or recessed, wall, ceiling or end mounting. The housing comes standard in a white, baked powder coat finish. Available in custom powder coat finishes or alternate metal finishes (please specify). External LED monitor light and test switch are standard on self-powered versions.

## UNIVERSAL DESIGN

The CWZ is a truly all-in-one exit solution that is ideal for distributor shelves and last minute jobs. Every CWZ includes the required components for surface (wall, ceiling & end) and recess (wall & ceiling) mount configurations. Single and double face panels are provided, as well as field installable inserts that let you select clear, mirror or white backgrounds. Chevrons are field installable.

## SPECIFICATIONS: BATTERY

The CWZ is designed with a maintenance free, nickel-cadmium battery providing a minimum emergency duration of 90 minutes. An optional 120 minute nickel-cadmium battery is available. Recharge time of the battery is less than twenty-four [24] hours. The battery operating temperature is from 50°F up to 104°F (10°C to 40°C).

## INSTALLATION

The CWZ can be configured on site for surface wall, ceiling or end mount as well as recessed wall or ceiling mount. Adjustable steel T-bar mounting brackets are supplied standard for recessed ceiling installation. Faceplates for the CWZ are constructed of clear, solid acrylic. The CWZ is suitable for indoor and damp installations.

## ORDERING LOGIC

Series	Operation	LED	Face No./Panel Color	Mounting	Options
CWZ	A (AC only)	R (red)	U <sup>1</sup> (universal faces)	M <sup>2</sup> (universal mounts)	AT (auto-test, SA only)
	B (self-powered)	G (green)			B (black finish)
					BA (brushed aluminum finish)
					CC (custom color)
					FL <sup>3</sup> (visual alarm)
					IF (inverted face)
					PA (polished aluminum finish)
					PK12 (12" pendant kit)
					UDC (universal 6 - 24VDC)
					120SP (120 min. emergency)
					120VDC (specify 2 or 4 wires)
					SW (special wording - specify)

**NOTE 1:** Single and double face panels included in the product box. Clear, mirror and white field installable inserts included in the product box.

**NOTE 2:** Surface (wall, ceiling & end) and Recess (wall & ceiling) mounting kits included in the product box.

**NOTE 3:** Visual alarm only with AT option.

**NOTE 4:** With 120VAC only.

## AUTOTEST

The FME auto-test system automatically performs one 5 minute discharge test monthly and every 6 months it performs two 30 minute discharge tests, 24 hours apart. This tests both full battery capacity and recharge capability. The information is communicated simply and intuitively to maintenance personnel via a single multi-color LED. No need to memorize complex indicator protocols. No confusing array of multiple, same colored LEDs that can be difficult to read from floor level.

● Steady Green:	Normal Operation:
● Flashing Green:	Testing Underway
● Flashing Red/Green:	High Charging
● Steady Red:	Battery Disconnected
● Flashing Red:	Battery Test Failure
● Red Double Blink:	Battery Charging Failure
● Red Three Blink:	LED Failure

## SELF-POWERED VERSIONS

The CWZ series is designed to operate on battery power in the event of a power failure. Both the battery and charger are completely contained within the standard enclosure. There are no external components and no alterations made to the external dimensions of the standard sign. Status is easily determined via an LED that indicates AC-ON. A push button test switch allows maintenance personnel to quickly confirm the operational status of the exit.

## WARRANTY

The CWZ comes with a 5-year factory warranty. Deliberate damage, misuse, or improper installation effectively cancel the warranty.

## DIMENSIONS (in, mm)

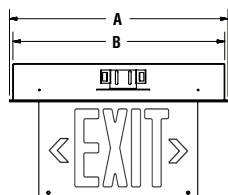
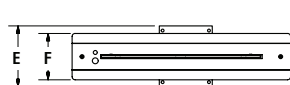

Recessed Ceiling

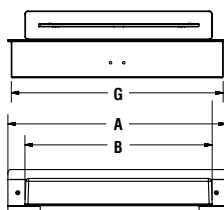

Recessed Wall

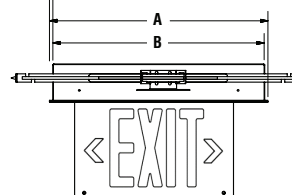
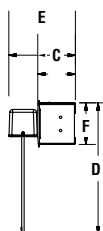

T - Bar Mount

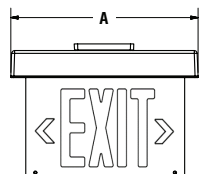
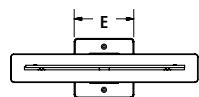
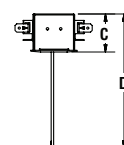

Surface Ceiling

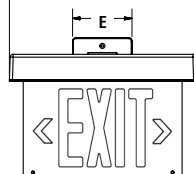
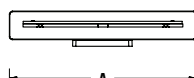
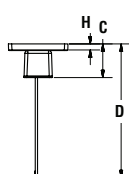

Surface Wall

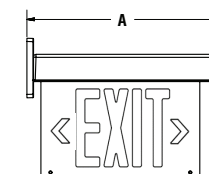
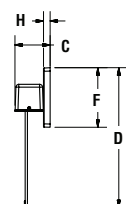

Surface End Wall

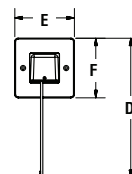

Model	A	B	C	D	E	F	G	H
Rec. Ceiling	16" (406mm)	16" (406mm)	3" (76mm)	10" (254mm)	4 1/2" (114mm)	3 1/2" (89mm)	N/A	N/A
Rec. Wall	16 1/2" (419mm)	14 1/2" (368mm)	2 3/4" (70mm)	9 3/4" (247mm)	5" (127mm)	3 1/4" (82.5mm)	16" (406mm)	N/A
T-Bar Mount	16 1/2" (419mm)	16" (406mm)	3" (76mm)	10" (254mm)	4 1/2" (114mm)	3 1/2" (89mm)	N/A	N/A
Surf. Ceiling	14 1/4" (362mm)	N/A	2 1/2" (63.5mm)	10" (254mm)	4 1/2" (114mm)	N/A	N/A	1/2" (13mm)
Surf. Wall	14 1/4" (362mm)	N/A	2 3/4" (70mm)	10" (254mm)	4 1/2" (114mm)	4 1/2" (368mm)	N/A	1/2" (13mm)
Surf. End	14 1/2" (368mm)	N/A	N/A	10" (254mm)	4 1/2" (114mm)	4 1/2" (368mm)	N/A	1/2" (13mm)

Wall